

Gauge Plates

2-48" (51-1219mm)

Gauge plates are used to check ovality of the I.D. of pipelines. Typically used in either progressive pigging applications or new pipeline construction. Gauge plates are usually cut to 95% of pipe I.D., but can be custom made to any O.D.

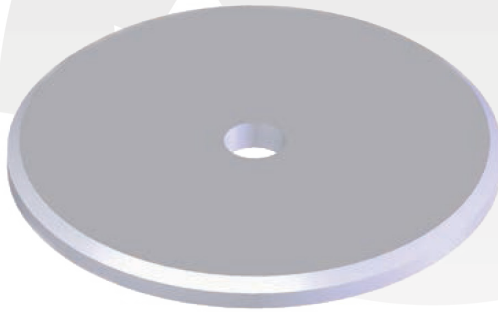

2" - 14" Standard Plates

- 1/4" Thick.
- Bevelled Edge.
- Non-Slotted.

Size	I.D. (in)
2"	0.563
3"	0.563
4"	0.563
6"	1.063
8"	1.063
10"	1.063
12"	1.063
14"	1.063

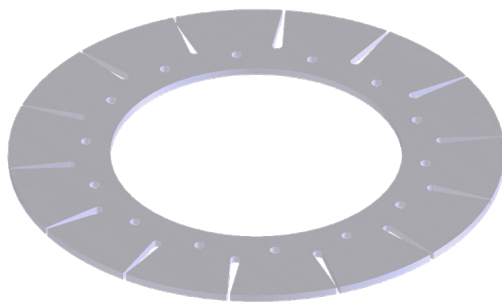

16" - 48" Standard Plates

- 3/8" Thick.
- Non-Bevelled.
- Slotted.
- Various bolt patterns and I.D.s available.

Size	I.D. (in)	# Holes
16"	8.750	8
18"	10.875	8
20"	10.875	12
22"	10.875	12
24"	14.125	14
26"	14.125	14
28"	16.125	16
30"	16.125	16
32"	20.125	24
34"	20.125	18
36"	20.125	22
38"	22.125	24
40"	22.125	24
42"	24.125	24
48"	32.125	24

*Plates are also available with the Series M or MDK metric bolt pattern.