

Guide Discs

16-48" (406-1219mm)

Durable. Reliable. Effective.

Apache guide discs are extremely versatile and can perform in bi-directional or uni-directional applications.

As with all of Apache products, the Series C disc was specifically developed to perform, efficiently and reliably. To enhance durability, it's made from Reliathane, Apache's special blend of wear-resistant polyurethane.

To enhance disc life, guide discs are available with a variety of wear-resistant additives. In fact, Apache developed a proprietary chemical resistant urethane to help protect against conditions, such as hydrogen sulphide, encountered in severe environments.

*Series C parts mount on different style pigs than our Series M.

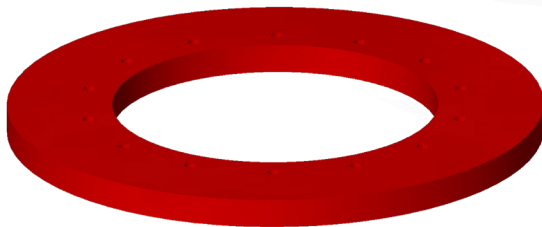

| Size | O.D | I.D | Part # |
|------|--------|--------|------------|
| 16" | 15.250 | 8.750 | 91-3220-16 |
| 18" | 17.250 | 10.875 | 91-3220-18 |
| 20" | 19.250 | 10.875 | 91-3220-20 |
| 22" | 21.250 | 10.875 | 91-3220-22 |
| 24" | 23.250 | 14.125 | 91-3220-24 |
| 26" | 25.250 | 14.125 | 91-3220-26 |
| 28" | 27.250 | 16.125 | 91-3220-28 |
| 30" | 29.250 | 16.125 | 91-3220-30 |
| 32" | 31.250 | 20.125 | 91-3220-32 |
| 34" | 33.250 | 20.125 | 91-3220-34 |
| 36" | 35.250 | 22.125 | 91-3220-36 |
| 38" | 37.250 | 22.125 | 91-3220-38 |
| 40" | 39.250 | 22.125 | 91-3220-40 |
| 42" | 41.250 | 24.250 | 91-3220-42 |
| 48" | 47.250 | 32.125 | 91-3220-48 |

Options Available:

- Wear-resistant additives.
- Custom I.D./O.D. bolt pattern and thickness available on request.
- High temperature material.